



CERTIFIED

Inorax-ST Server Cabinet

A cost effective server rack cabinet system developed for independent use and Data Center environments. inorax-ST server rack cabinet system is designed and engineered for demanding Data Center environments. It is designed to house all servers manufactured by major brands including HP, Dell, Sun, Cisco, Juniper, IBM, Compaq to name but a few. To achieve optimum versatility within the server rack, users can set multiple depths throughout the cabinet by adjustable 19" mounting rails mounted on heavy duty side supports. Horizontally divided side panels provide ease of access and convenient post-installation maintenance. Optional % 80 perforations on front and rear doors enable optimum airflow within the rack cabinet. Optional cable tray channels can be fitted on top of the rack provides perfect cable routing eliminating the need for raised floor systems. Flat-pack option enables savings up to 60% in the transport cost and warehouse space

Technical Features

Material	1-1,2-1,5-2mm Steel
Color	RAL 7035 or RAL 9005
Compliance	RoHS, UL Certified
Packaging	Assembled or unassembled
Maximum Static Load	Up to 1500 kg. (in 600x600 mm)
Finish	Frame, doors, side panels, top and bottom covers. Electrostatic Powder Paint, 19" mounting rails: Zinc-plated

Standard Configuration:

- Perforated front and rear doors, Free Air Ratio (Fea): %65
- Front & rear doors with swing handle Multi point-espagnolette
- Solid Side Panels with cylindrical locks and latches
- Internal top sheet with 3 cable entries for 800 width,
1 cable entry for 600 width racks and fan cut-outs
- 2 Pairs of depth adjustable heavy duty 19" Mounting Rails
- 2 Pairs of Adjustable Feet
- Bottom cover with 3 cable entries for 800 width,
1 cable entry for 600 width racks

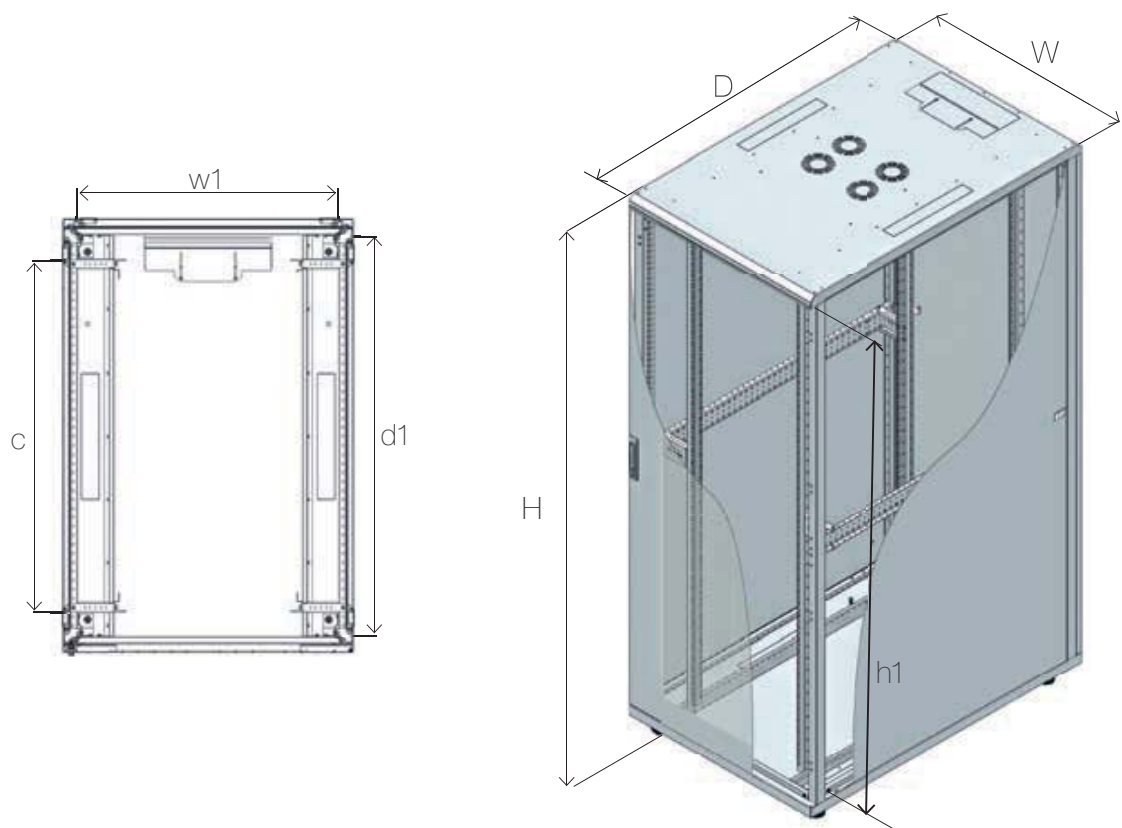

Order Information

Height U	Outer Width (w) mm	Outer Depth (D) mm	Outer Height (H) mm	Inner Width (w1) mm	Inner Depth (d1) mm	Inner Height (h1) mm	19" Rails Adjustable Depth Range (c)	Weight kg	Part No
26U	600	1000	1322	503	950	1162	123 - 773	84,0	CSS-X-2660A
26U	600	1200	1322	503	1150	1162	123 - 973	95,8	CSS-X-2662A
36U	600	1000	1766	503	950	1607	123 - 773	104,9	CSS-X-3660A
36U	600	1200	1766	503	1150	1607	123 - 973	116,5	CSS-X-3662A
39U	800	1000	1900	703	950	1740	123 - 773	130,2	CSS-X-3980A
42U	600	1000	2033	503	950	1873	123 - 773	117,2	CSS-X-4260A
42U	600	1100	2033	503	1050	1873	123 - 873	123,0	CSS-X-4261A
42U	600	1200	2033	503	1150	1873	123 - 973	129,0	CSS-X-4262A
42U	800	1000	2033	703	950	1873	123 - 773	136,9	CSS-X-4280A
42U	800	1100	2033	703	1050	1873	123 - 873	143,6	CSS-X-4281A
42U	800	1200	2033	703	1150	1873	123 - 973	150,5	CSS-X-4282A
42U	1000	1000	2033	903	950	1873	123 - 773	156,9	CSS-X-4211A
47U	600	1000	2255	503	950	2095	123 - 773	126,7	CSS-X-4760A
47U	600	1100	2255	503	1050	2095	123 - 873	133,0	CSS-X-4761A
47U	600	1200	2255	503	1150	2095	123 - 973	139,3	CSS-X-4762A
47U	800	1000	2255	703	950	2095	123 - 773	147,3	CSS-X-4780A
47U	800	1100	2255	703	1050	2095	123 - 873	154,5	CSS-X-4781A
47U	800	1200	2255	703	1150	2095	123 - 973	161,7	CSS-X-4782A

X (Color code): 7:RAL 7035 Light Grey, 9:RAL 9005 Black

Components of inorax-ST

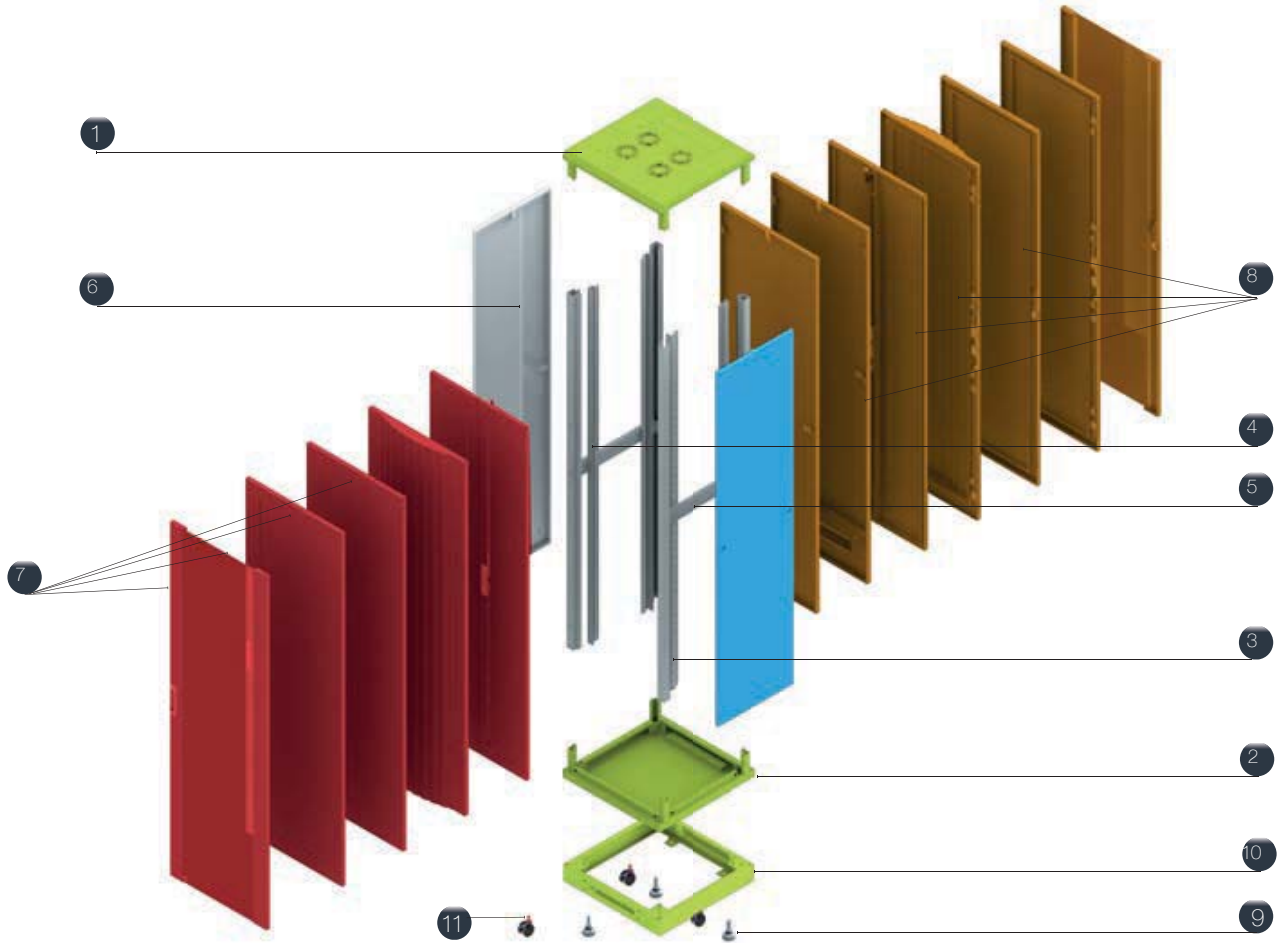

- 1- Top Cover
- 2 - Bottom Cover
- 3 - Vertical Profiles
- 4 - 19" Mounting Rails
- 5 - Side Support Rails
- 6 - Side Panel
- 7 - Front Door Options
- 8 - Rear Door Options

- 9 - Adjustable Feet
- 10 - Plinth
- 11 - Castor



Page : 102



Page : 103



Page : 104



Page : 105



Page : 106 - 107

Components of inorax-ST

Top Cover

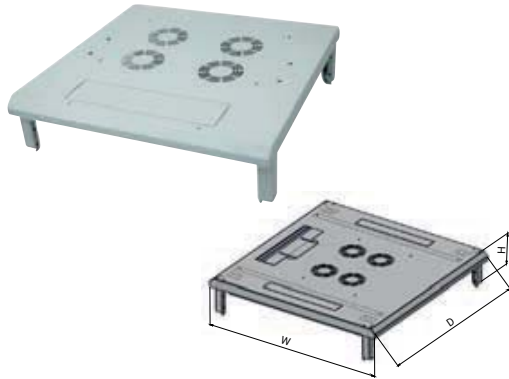

Material	1.5 mm Steel	Finish	Electrostatic Powder Paint
Color	RAL 7035 (Light Grey) and RAL 9005 (Black)		

W (mm)	D (mm)	H (mm)	Weight kg	Part No
600	600	154	10,8	CSZ-X-YY660-0401
600	800	154	12,7	CSZ-X-YY680-0401
600	1000	154	14,6	CSZ-X-YY600-0401
600	1100	154	15,5	CSZ-X-YY610-0401
600	1200	154	16,4	CSZ-X-YY620-0401
800	800	154	16,7	CSZ-X-YY880-0401
800	1000	154	19,6	CSZ-X-YY800-0401
800	1100	154	21,0	CSZ-X-YY810-0401
800	1200	154	22,4	CSZ-X-YY820-0401

Bottom Cover



Material	1.5 mm Steel	Finish	Electrostatic Powder Paint
Color	RAL 7035 (Light Grey) and RAL 9005 (Black)		

W (mm)	D (mm)	H (mm)	Weight kg	Part No
600	600	154	11,1	CSZ-X-YY660-0403
600	800	154	13,0	CSZ-X-YY680-0403
600	1000	154	15,0	CSZ-X-YY600-0403
600	1100	154	15,9	CSZ-X-YY610-0403
600	1200	154	16,9	CSZ-X-YY620-0403
800	800	154	17,2	CSZ-X-YY880-0403
800	1000	154	20,0	CSZ-X-YY800-0403
800	1100	154	21,5	CSZ-X-YY810-0403
800	1200	154	22,9	CSZ-X-YY820-0403

Vertical Profiles

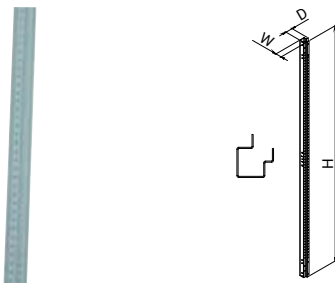

Material	1.5 mm Steel	Finish	Electrostatic Powder Paint
Color	RAL 7035 (Light Grey) and RAL 9005 (Black)		

H (U)	W (mm)	D (mm)	H (mm)	Weight kg	Part No
16U	48,5	57	754	1,4	CSZ-X-16YY0-0300
22U	48,5	57	1021	1,8	CSZ-X-22YY0-0300
26U	48,5	57	1199	2,2	CSZ-X-26YY0-0300
32U	48,5	57	1465	2,6	CSZ-X-32YY0-0300
36U	48,5	57	1643	2,9	CSZ-X-36YY0-0300
39U	48,5	57	1777	3,2	CSZ-X-39YY0-0300
42U	48,5	57	1910	3,5	CSZ-X-42YY0-0300
47U	48,5	57	2132	3,8	CSZ-X-47YY0-0300

19" Mounting Rails



Material	2 mm Steel	Finish	Zinc-Plated
-----------------	------------	---------------	-------------

H (U)	W (mm)	D (mm)	H (mm)	Weight kg	Part No
16U	33	52	753	1,0	CSZ-0-16YY0-0600
22U	33	52	1020	1,3	CSZ-0-22YY0-0600
26U	33	52	1198	1,5	CSZ-0-26YY0-0600
32U	33	52	1464	1,8	CSZ-0-32YY0-0600
36U	33	52	1642	2,0	CSZ-0-36YY0-0600
39U	33	52	1776	2,2	CSZ-0-39YY0-0600
42U	33	52	1909	2,4	CSZ-0-42YY0-0600
47U	33	52	2131	2,7	CSZ-0-47YY0-0600

X : Color code = 7: RAL 7035 (Grey); 9: RAL 9005 (Black)

Side Support Rails

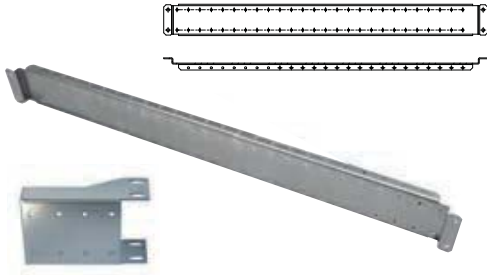

Material	2 mm Steel	Finish	Zinc-Plated
Cabinet W (mm)	Cabinet D (mm)	Weight kg	Part No
600	600	0,7	CSZ-0-YY660-0700
600	800	0,8	CSZ-0-YY680-0700
600	1000	0,8	CSZ-0-YY600-0700
600	1100	0,9	CSZ-0-YY610-0700
600	1200	0,9	CSZ-0-YY620-0700
800	800	0,8	CSZ-0-YY880-0700
800	1000	0,9	CSZ-0-YY800-0700
800	1100	1,0	CSZ-0-YY810-0700
800	1200	1,0	CSZ-0-YY820-0700

Side Panel

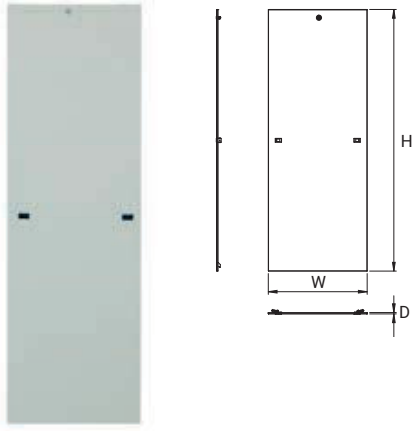

Material	1 mm Steel	Finish	Electrostatic Powder Paint	
Color	RAL 7035 (Light Grey) and RAL 9005 (Black)			
H (U)	W (mm)	D (mm)	H (mm)	Part No
16U	600	22	749	CSZ-X-16Y60-0501
22U	600	22	1016	CSZ-X-22Y60-0501
22U	800	22	1016	CSZ-X-22Y80-0501
26U	600	22	1194	CSZ-X-26Y60-0501
26U	800	22	1194	CSZ-X-26Y80-0501
26U	1000	22	1194	CSZ-X-26Y00-0501
32U	600	22	1460	CSZ-X-32Y60-0501
32U	800	22	1460	CSZ-X-32Y80-0501
36U	600	22	1638	CSZ-X-36Y60-0501
36U	800	22	1638	CSZ-X-36Y80-0501
36U	1000	22	1638	CSZ-X-36Y00-0501
36U	1200	22	1638	CSZ-X-36Y20-0501
39U	800	22	1772	CSZ-X-39Y80-0501
39U	1000	22	1772	CSZ-X-39Y00-0501
42U	600	22	1905	CSZ-X-42Y60-0501
42U	800	22	1905	CSZ-X-42Y80-0501
42U	1000	22	1905	CSZ-X-42Y00-0501
42U	1100	22	1905	CSZ-X-42Y10-0501
42U	1200	22	1905	CSZ-X-42Y20-0501
47U	600	22	2127	CSZ-X-47Y60-0501
47U	800	22	2127	CSZ-X-47Y80-0501
47U	1000	22	2127	CSZ-X-47Y00-0501
47U	1100	22	2127	CSZ-X-47Y10-0501
47U	1200	22	2127	CSZ-X-47Y20-0501

Rear Metal Solid Panel

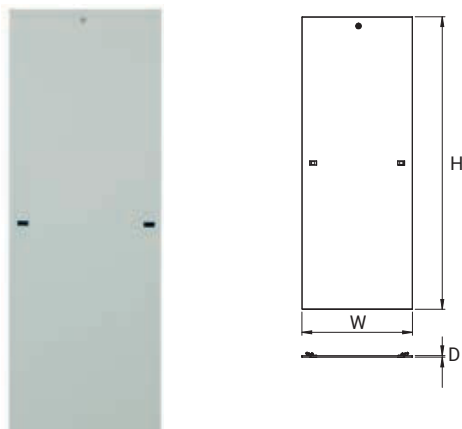

Material	1 mm Steel	Finish	Zinc-Plated		
H (U)	W (mm)	D (mm)	H (mm)	Weight kg	Part No
16U	600	23	752	5,1	CSZ-X-166Y0-0901
22U	600	23	1018	6,7	CSZ-X-226Y0-0901
22U	800	23	1018	8,8	CSZ-X-228Y0-0901
26U	600	23	1196	7,8	CSZ-X-266Y0-0901
26U	800	23	1196	10,2	CSZ-X-268Y0-0901
32U	600	23	1463	9,5	CSZ-X-326Y0-0901
32U	800	23	1463	12,3	CSZ-X-328Y0-0901
36U	600	23	1641	10,6	CSZ-X-366Y0-0901
36U	800	23	1641	13,8	CSZ-X-368Y0-0901
39U	800	23	1774	14,9	CSZ-X-398Y0-0901
42U	600	23	1907	12,2	CSZ-X-426Y0-0901
42U	800	23	1907	16,0	CSZ-X-428Y0-0901
47U	600	23	2130	13,6	CSZ-X-476Y0-0901
47U	800	23	2130	17,7	CSZ-X-478Y0-0901

X : Color code = 7: RAL 7035 (Grey); 9: RAL 9005 (Black)

Metal Solid Door

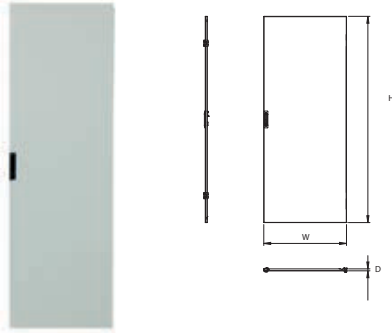

Glass Door

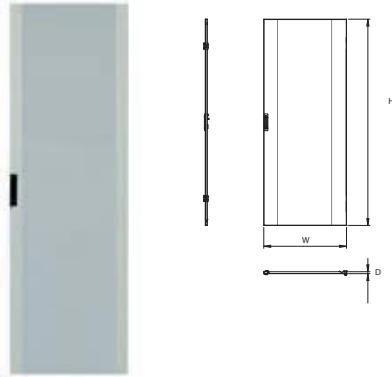

Perforated Flat Door

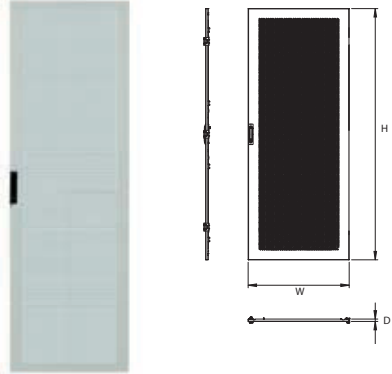

Double Perforated Door

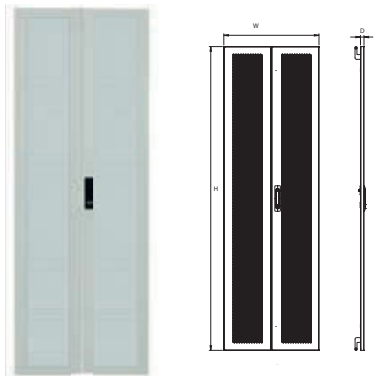

Material	1.2 mm Steel	Finish	Electrostatic Powder Paint		
Color	RAL 7035 (Light Grey) and RAL 9005 (Black)				
H (U)	W (mm)	D (mm)	H (mm)	Weight kg	Part No
16U	600	22	749	6,87	CSZ-X-166Y0-0902
22U	600	22	1016	8,94	CSZ-X-226Y0-0902
22U	800	22	1016	11,26	CSZ-X-228Y0-0902
26U	600	22	1194	10,32	CSZ-X-266Y0-0902
26U	800	22	1194	12,97	CSZ-X-268Y0-0902
32U	600	22	1460	12,39	CSZ-X-326Y0-0902
32U	800	22	1460	15,54	CSZ-X-328Y0-0902
36U	600	22	1638	13,77	CSZ-X-366Y0-0902
36U	800	22	1638	17,26	CSZ-X-368Y0-0902
39U	800	22	1772	18,54	CSZ-X-398Y0-0902
42U	600	22	1905	15,84	CSZ-X-426Y0-0902
42U	800	22	1905	19,83	CSZ-X-428Y0-0902
47U	600	22	2127	17,56	CSZ-X-476Y0-0902
47U	800	22	2127	21,97	CSZ-X-478Y0-0902

Material	1.2 mm Steel	Finish	Electrostatic Powder Paint		
Color	RAL 7035 (Light Grey) and RAL 9005 (Black)				
H (U)	W (mm)	D (mm)	H (mm)	Weight kg	Part No
16U	600	22	749	5,53	CSZ-X-166Y0-0903
22U	600	22	1016	7,42	CSZ-X-226Y0-0903
22U	800	22	1016	9,77	CSZ-X-228Y0-0903
26U	600	22	1194	8,68	CSZ-X-266Y0-0903
26U	800	22	1194	11,42	CSZ-X-268Y0-0903
32U	600	22	1460	10,56	CSZ-X-326Y0-0903
32U	800	22	1460	13,9	CSZ-X-328Y0-0903
36U	600	22	1638	11,82	CSZ-X-366Y0-0903
36U	800	22	1638	15,55	CSZ-X-368Y0-0903
39U	800	22	1772	16,79	CSZ-X-398Y0-0903
42U	600	22	1905	13,7	CSZ-X-426Y0-0903
42U	800	22	1905	18,02	CSZ-X-428Y0-0903
47U	600	22	2127	15,27	CSZ-X-476Y0-0903
47U	800	22	2127	20,09	CSZ-X-478Y0-0903

Material	1.2 mm Steel	Color	RAL 7035 (Light Grey) and RAL 9005 (Black)		
Finish	Electrostatic Powder Paint	Perforation Rate	65%		
H (U)	W (mm)	D (mm)	H (mm)	Weight kg	Part No
26U	600	22	1194	7,81	CSZ-X-266Y0-0904
36U	600	22	1638	10,15	CSZ-X-366Y0-0904
39U	800	22	1772	14,02	CSZ-X-398Y0-0904
42U	600	22	1905	11,80	CSZ-X-426Y0-0904
42U	800	22	1905	15,17	CSZ-X-428Y0-0904
47U	600	22	2127	12,97	CSZ-X-476Y0-0904
47U	800	22	2127	16,69	CSZ-X-478Y0-0904

Material	1.2 mm Steel	Color	RAL 7035 (Light Grey) and RAL 9005 (Black)		
Finish	Electrostatic Powder Paint	Perforation Rate	65%		
H (U)	W (mm)	D (mm)	H (mm)	Weight kg	Part No
26U	600	22	1194	11,99	CSZ-X-266Y0-0908
36U	600	22	1638	15,70	CSZ-X-366Y0-0908
39U	800	22	1772	21,19	CSZ-X-398Y0-0908
42U	600	22	1905	18,16	CSZ-X-426Y0-0908
42U	800	22	1905	22,83	CSZ-X-428Y0-0908
47U	600	22	2127	20,01	CSZ-X-476Y0-0908
47U	800	22	2127	25,16	CSZ-X-478Y0-0908

X : Color code = 7: RAL 7035 (Grey); 9: RAL 9005 (Black)

High Perforation Rated Flat Door

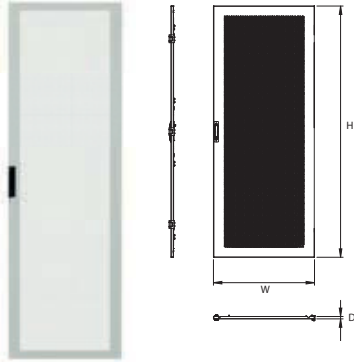

Material	1.2 mm Steel	Color	RAL 7035 (Light Grey) and RAL 9005 (Black)		
Finish	Electrostatic Powder Paint		Perforation Rate	80%	
H (U)	W (mm)	D (mm)	H (mm)	Weight kg	Part No
26U	600	22	1194	7,51	CSZ-X-266Y0-0909
36U	600	22	1638	9,85	CSZ-X-366Y0-0909
39U	800	22	1772	13,72	CSZ-X-398Y0-0909
42U	600	22	1905	11,50	CSZ-X-426Y0-0909
42U	800	22	1905	14,87	CSZ-X-428Y0-0909
47U	600	22	2127	12,67	CSZ-X-476Y0-0909
47U	800	22	2127	16,39	CSZ-X-478Y0-0909

High Perforation Rated Double Door



Material	1.2 mm Steel	Color	RAL 7035 (Light Grey) and RAL 9005 (Black)		
Finish	Electrostatic Powder Paint		Perforation Rate	80%	
H (U)	W (mm)	D (mm)	H (mm)	Weight kg	Part No
26U	600	22	1194	11,69	CSZ-X-266Y0-0911
36U	600	22	1638	15,40	CSZ-X-366Y0-0911
39U	800	22	1772	20,89	CSZ-X-398Y0-0911
42U	600	22	1905	17,86	CSZ-X-426Y0-0911
42U	800	22	1905	22,53	CSZ-X-428Y0-0911
47U	600	22	2127	19,71	CSZ-X-476Y0-0911
47U	800	22	2127	24,86	CSZ-X-478Y0-0911

Rear Metal Panel with Cable Entry



Material	1 mm Steel		Finish	Electrostatic Powder Paint	
Color	RAL 7035 (Light Grey) and RAL 9005 (Black)				
H (U)	W (mm)	D (mm)	H (mm)	Weight kg	Part No
3U	600	23	133	0,97	CSZ-X-036Y0-0915
3U	800	23	133	1,35	CSZ-X-038Y0-0915
4U	600	23	177	1,24	CSZ-X-046Y0-0915
4U	800	23	177	1,71	CSZ-X-048Y0-0915
5U	600	23	222	1,52	CSZ-X-056Y0-0915
5U	800	23	222	2,06	CSZ-X-058Y0-0915
6U	600	23	266	1,79	CSZ-X-066Y0-0915
6U	800	23	266	2,42	CSZ-X-068Y0-0915

Adjustable Cable Entry Panel with EPDM Gasket



Material	1 mm Steel		Finish	Electrostatic Powder Paint	
Color	RAL 7035 (Light Grey) and RAL 9005 (Black)				
W (mm)	D (mm)	H (mm)	Weight kg	Part No	
350	152	20	0,53	CSZ-X-YYYY0-0803	

X : Color code = 7: RAL 7035 (Grey); 9: RAL 9005 (Black)

Adjustable Feet

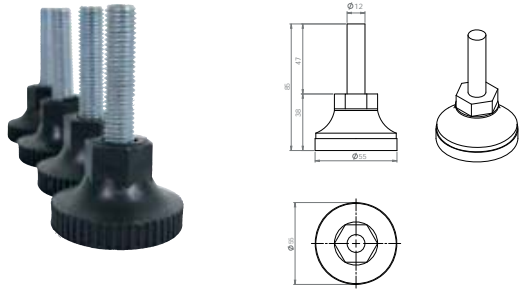

Material	Steel and Plastic ABS	Finish	Zinc Plated
Packaging	4 pieces in a box		

Maximum Static Load	Set Weight kg	Part No
600 kg / piece	0.35	CCA-0-7014

Multi Point Lock for Double Doors

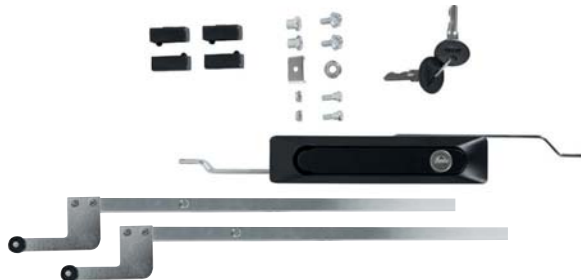

Material	Steel, Polyamide
Packaging	1 piece in a box
Part No	CSZ-0-YYYY0-1005

Four Point Lock for Single Perforated Door



Material	Steel, Polyamide
Packaging	1 piece in a box
Part No	CSZ-0-YYYY0-1004

Three Point Lock for Single Perforated Door



Material	Steel, Polyamide
Packaging	1 piece in a box
Part No	CSZ-0-YYYY0-1006

Castor Set

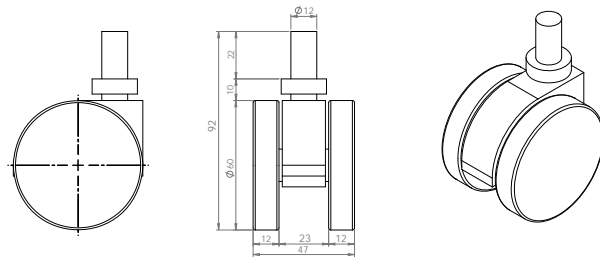

Material	Steel and Plastic ABS	Finish	Zinc Plated
Packaging	2 pcs with stopper and 2 pcs without Stopper in a box		

Single Point Lock



Maximum Static Load	Set Weight kg	Part No
75 kg / piece	0.77	CCA-0-7015

Material	Polyamide
Packaging	1 piece in a box
Part No	CPZ-0-YYYY0-1003

Cylindrical Lock for Side Panel



Material	Zamak, Steel
Packaging	1 piece in a box
Part No	CPZ-0-YYYY0-1001

Cylindrical Lock for Rear Metal Solid Panel



Material	Zamak, Steel
Packaging	1 piece in a box
Part No	CPZ-0-YYYY0-1002

Intelligent Rack

Technical Features

- H x W x D: 42U x 800mm x 1000mm
- Steel frame chassis according to 25mm DIN system
- 1200 kg carrying capacity
- Depth adjustable 19" mounting rails with U marking
- Front and rear doors with internal frame and 80% perforation ratio
- Electronic lock with keypad, integrated to EMMS System
- Side panels, top and bottom sheets are bolted internally
- Two-piece top sheet with adjustable cable entry
- Three-piece bottom sheet with adjustable cable entry
- Adjustable feet
- Earthing kit and earthing bar
- RAL 7035 powder coated

Accessories

- Four cable management panels with 5 cable guides
- 1U 19" blank panels
- Shielded cable channels for data and power cabling
- 3 pcs of radial fans with 625 m³/h for cooling (N+1 redundancy)
- Two temperature sensors at upper and lower part of the rack

Power Supply

- 230V and 400V (three phase) power feed
- Redundant power feed
- Cable connections according to DIN VDE 0113

